



SOLUTIONS & PROCESSES FOR AIR HANDLING & DUST CONTROL

INSIDE THIS ISSUE

- 1 The Dust Problem**
- 2 Dust Collection**
- 3 Classification of Grain Tech Dust Collectors according to type of application**
- 4 Features of the Grain Tech Reverse Pulse Filter Collector Series**
- 5 Grain Tech Cyclone Dust Collectors**
- 6 Fans**
 - High Pressure (HP) models
 - Low Pressure (LP) models
 - Material Handling Fans
 - Silencers
- 7 Associated Air Handling & Dust Control Equipment**
 - Rotary Valves
 - Slide Gate & Butterfly Valves
 - Diverter Valves
 - Explosion Venting Units
- 8 Process Applications**

PROVISION OF PROVEN AND OPTIONAL EQUIPMENT SUPPLY

Grain Tech has over 30 years experience in providing process air handling and dust control solutions within the wide range of industrial processing, bulk and general materials handling industries either as new applications, extension to process requirements or as upgrades to an existing installation.

For each application the most suitable type of filter unit and associated equipment items are evaluated and detailed to ensure optimum performance with the arrangement design and equipment planning-in detailing being completed according to the existing conditions and process operating parameters.

In many cases the called for air handling and dust control requirements have been satisfactory completed by Grain Tech for existing previous applications enabling a rapid and proven solution to the called for application.

Incorporation of standard designed and fabricated units offers practicality and economics with component assemblies and equipment items being readily available to ensure continuous service operation.

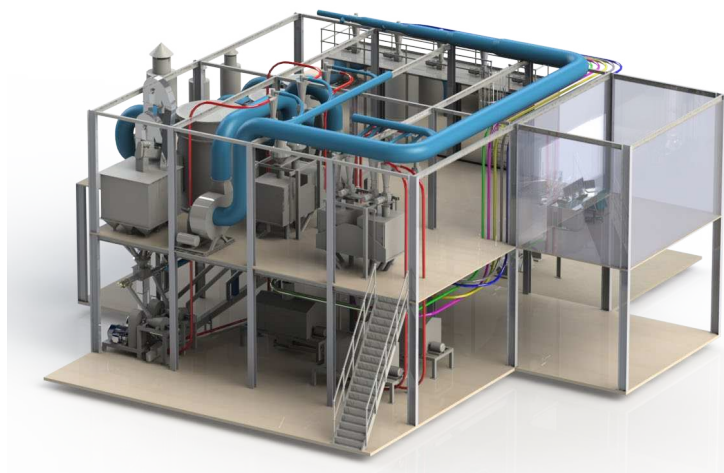

1 - THE DUST PROBLEM

When bulk materials and products are moved from one place to another, dust particles are released and will be emitted to the surroundings, polluting the place and contaminating the air, thus endangering the health of the operators.

Although this problem is very well known within grain and seed plants, several other types of industry are harassed by similar troubles and experiences from the particularly dust-plagued grain industry have been turned to good account within many related fields of operation.

Improvement of working conditions is probably one of the most common reason for installations of a dust collector system and its importance should not be underestimated. In any process where dust is produced the elimination and control of the dust pays dividends in improved efficiency for both staff and machines.

Within grain processing and drying plants one of the secondary reasons for a dust collecting system is the cleaning effect on the product when conveying it to and from dryers, processing equipment tempering bins etc.



2 - DUST COLLECTION

The removal of dust is a complex matter. Further information on the different dust reducing systems offered by Grain Tech can be found in the following information on dust collecting systems, which takes into account some of the various factors and local requirements.

However effective the enclosure of dust emitting machines and conveying equipment, large volumes of air are still required to extract the dust at the source before it pollutes the surroundings. The most intricate problem involved when countering the nuisance is how to separate the dust particles from the exhaust air prior to its being expelled to the atmosphere.

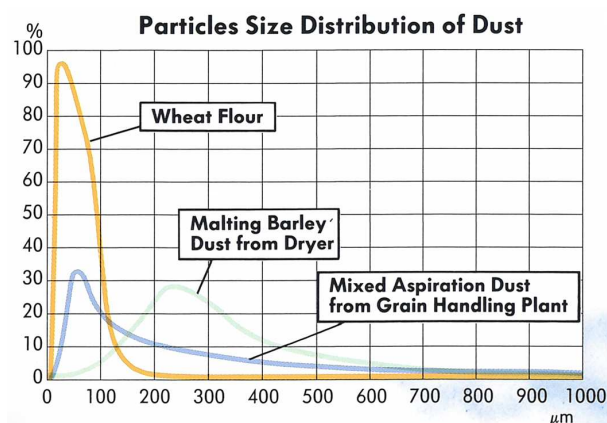
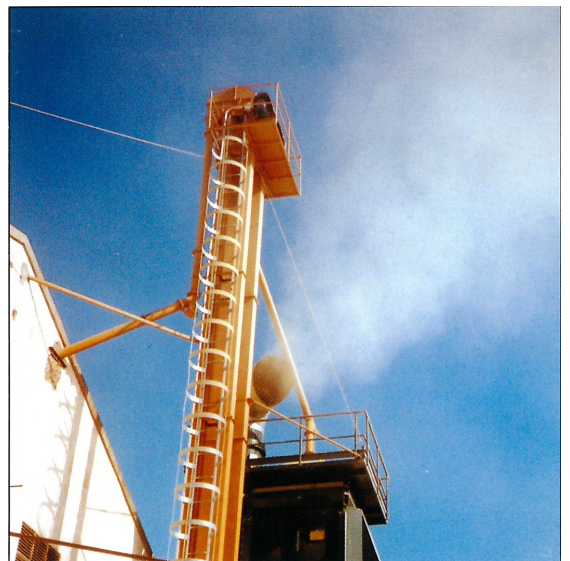

The particle size distribution varies very much with the process and the type of dust. The diagram indicates this relationship for some typical types of dust.



3 - DUST FILTER COLLECTION SERIES: CLASSIFICATION

According to the method of dust removal:

- Low Pressure Dust Filter Collector
- High Pressure Dust Filter Collector
- Insertable Type Reverse Pulse Filter Collector
- Reversed Air Filter Collector
- High Pressure Envelope Type Dust Collector
- Local Application Filter Units

According to the process of dust removal:

- Removing Dust On-Line
- Removing Dust Off-Line

A: TBLMd SERIES LOW PRESSURE PULSE DUST FILTER COLLECTOR: ASSEMBLY ARRANGEMENT

This unit includes an upper plenum chamber, an intermediate housing assembly, a lower assembly, a dust discharging device and is fitted with an air jet dust pulse cleaning system.

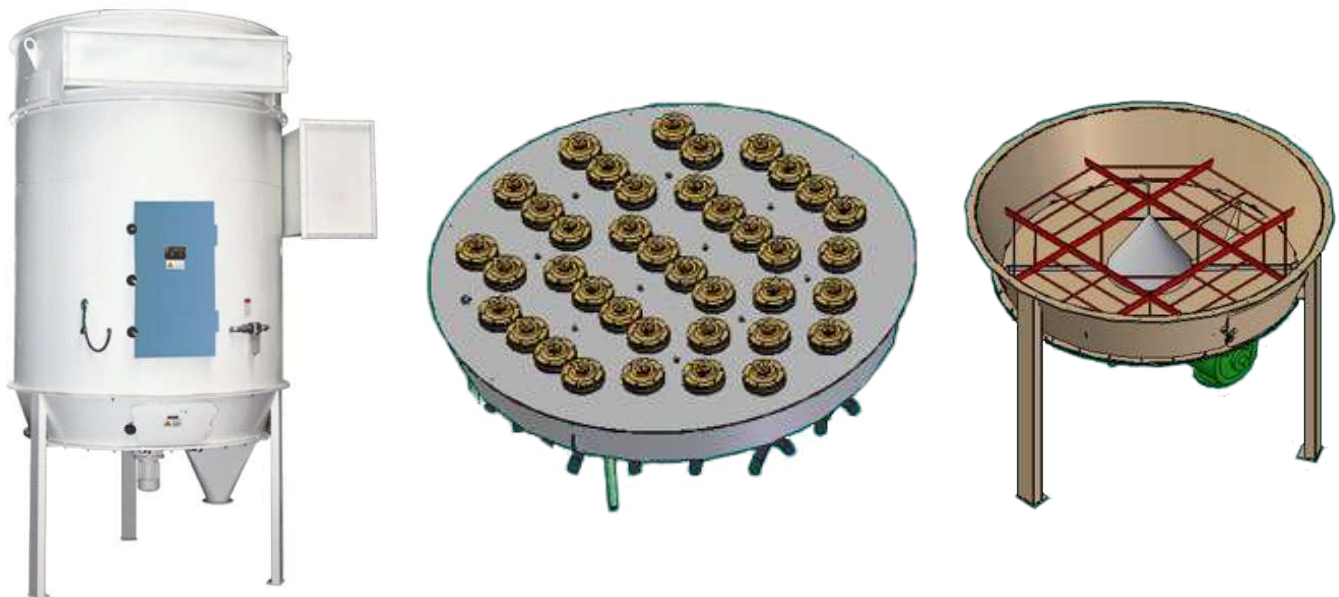

TBLMd SERIES LOW PRESSURE PULSE DUST FILTER COLLECTOR: PRINCIPLE OF OPERATION

The dust laden air enters the middle chamber via a tangential air inlet, where the large particle sized dust separates as it settles into the hopper sections, while the dust laden air with small particle sized dust is passed through filtering sleeves to be purified, this air then enters the upper plenum chamber and is discharged from the clean air outlet. The fine particle sized dust is deposited on the outer surface of the filtering sleeves where this builds up to assist the filtering effect to be regularly removed via a low pressure air jet flow supplied from an air receiver and manifold assembly to solenoid valves operating sequentially from a control timer capable of regulating both length of the reverse pulse duration and the frequency timing of the reverse pulse. The reverse pulse jet of air enters the filter sleeve through a jet orifice to cause the respective filtering sleeve to expand sharply for an instant in order to shake off the dust build up on the outer surface of the filtering sleeve. Discharged dust material transfers to the flat bottom type or conically arranged hopper section to be discharged through an air lock seal to the following process flow or receiving hopper. The regulated reverse pulse action sequentially applied to the filtering sleeves ensures that these function effectively and maintain a normal operating mode.

TBLMd SERIES LOW PRESSURE PULSE DUST FILTER COLLECTOR: TECHNICAL PARAMETERS

A range of models are available having the following features:

- Quantity of filter sleeves: 18, 26, 39, 52, 78, 104, 130, 168, 180
- Filtering area: from 12 - 135 m²
- Treatment air volume from: 4050 - 40,500 m³/h
- Filter air speed: ≤ 3 m/min
- Filtering sleeve's diameter × length: Ø120 × 1.8, 2, 2.4 mm
- Dust removal efficiency: ≤ 99.5%

TBLMd SERIES LOW PRESSURE PULSE DUST FILTER COLLECTOR: OPERATING CONDITIONS

- This type of dust filter collector is not applicable for treating dust-containing air running under high temperature and high humidity as well as air within corrosive atmospheric environments.
- The dust filter collector is equipped with Terylene needle felt as the filter material, the suitable temperature of which is lower than 120°C, if it is expected to handle humid dust laden air, this must be taken into account when selecting equipment models. Special filter material may be provided to suit various applications.
- The normal working air pressure of the dust collector is 0.03 - 0.08 MPa.
- Input voltage for the pulse-controller is AC220 (1±5%)V, 50Hz, working environment: -20°C +50°C
- Input voltage for the solenoid valve: DC24V, electrical current: 0.8A - 1A, working environment -20°C +50°C
- Working voltage for the airlock: AC220/400 (1±5%)V, the material should not contain quantities of long fibrous material.
- Working voltage for the following conveyor's motor would be AC415 (1±5%)V

TBLMd SERIES LOW PRESSURE PULSE DUST FILTER COLLECTOR: MAJOR WORKING PARTS



Reverse Pulse Controller

- Adjusting scope of impulse duration: max 0.3s, min 0.03s
- Adjusting scope of pulse interval: 3 - 60s
- Output circuit: 1 - 60 for option or matched with the number of the solenoid valves for the dust collector
- Working condition: -10°C +60°C



Solenoid Valves

- The function of the solenoid valve is to regulate the compressed air pulse and flow to the individual banks of filter socks, to ensure effective cleaning. Each bank is fitted with an electrically controlled solenoid valve.
- The machine is equipped with TDFD type solenoid valves, which have a compact design and are capable of withstanding large air volumes while retaining stable running performance, long service life of diaphragms (1,000,000 cycles) and high sensitivity.

TBLMd SERIES LOW PRESSURE PULSE DUST FILTER COLLECTOR: MAJOR WORKING PARTS CONT.

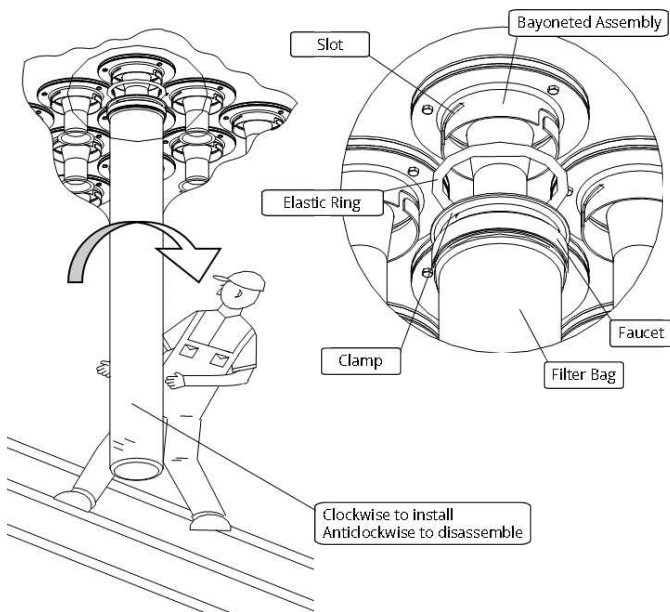

- Bayoneted type mechanism for assembling and disassembling filter sleeves.
- The mechanism guarantees a sound sealing effect and enables rapid disassembly and reassembly for maintenance requirements. The sealing ring ensures that the fitting will not leak following assembly.



TBLMd SERIES LOW PRESSURE PULSE DUST FILTER COLLECTOR: DESIGN ARRANGEMENT

- This series of dust filter collector is fabricated with a round body section and may be fitted with either a conical hopper or flat bottom sweep arm discharge according to the planning-in requirements and type of dust laden product material being handled. The body section may be fitted with an explosive relief panel to meet specific safety requirements.
- The inlet incorporates a tangential entry into the main chamber to enable larger particle sized material to drop into the hopper section through cyclonic action. This enables a very high dust removal rate to be achieved when handling heavy type dust concentration loads. This series of dust filter collector is capable of consistently handling high air volumes within general dust collection and process dust handling applications.
- The high efficiency reverse pulse air jet to each group of filter socks is regulated for both length of pulse and frequency of pulse from an adjustable controller with the electro magnetic diaphragm valve having capacity to handle several filter sleeves at one time thus optimising service life and operating efficiency.
- The filter socks are located up within the filter collector to the upper cell plate by bayoneted type connection. These provide quick mounting/dismantling assemblies for rapid and simple maintenance with improved efficiency and minimum labour requirements.

TBLMd SERIES LOW PRESSURE PULSE DUST FILTER COLLECTOR: DESIGN CHARACTERISTICS

- The pulse controller is equipped with both manual and automatic air injection regulation control to optimise the cleaning needs. It is also equipped with a pressure regulator, which makes cleaning more accurate and effective.
- The cell plate openings are processed by a special boring machine to avoid thermal deformation which may be generated from manual cutting. This feature ensures close tolerance clamp fitting without the possibility of air leakage.
- The top of the upper plenum chamber is designed so as to facilitate easy replacement and inspection of the solenoid valves.
- The dust discharge hopper assembly is equipped with grids which ensures protection against the possibility of socks dropping and to avoid any likelihood of damage to the discharge sweep arm or rotary valve.
- The upper, middle and lower housing assemblies are all equipped with operation inspection doors for maintenance.

B: TLMC SERIES INSERTABLE TYPE REVERSE PULSE DUST COLLECTOR

- The insertable type filter collector range is designed for local dust point operation, such as pneumatic conveying, material transportation, packaging machines etc. These models offer a compact structure, flexible in installation and low resistance. The air volume capacity range is from: 700 - 6500 m³/hr. These filters can be placed on the top of silos, intake tip hoppers and other containers to achieve separation of dust and air, the collected dust is directed back to the original container. They can also serve as a type of ventilator in the work place to effectively improve the working environment.
- The sleeves of these filters are the flat envelope type, which ensures good air permeability and increases the units treatment air volume capacity. Pulse cleaning efficiency, coupled with effective cleaning procedures makes operating resistance low and enables high unit filter capacities.
- By opening the top access lid, the filter sleeve can be easily removed and replaced providing ease of servicing.

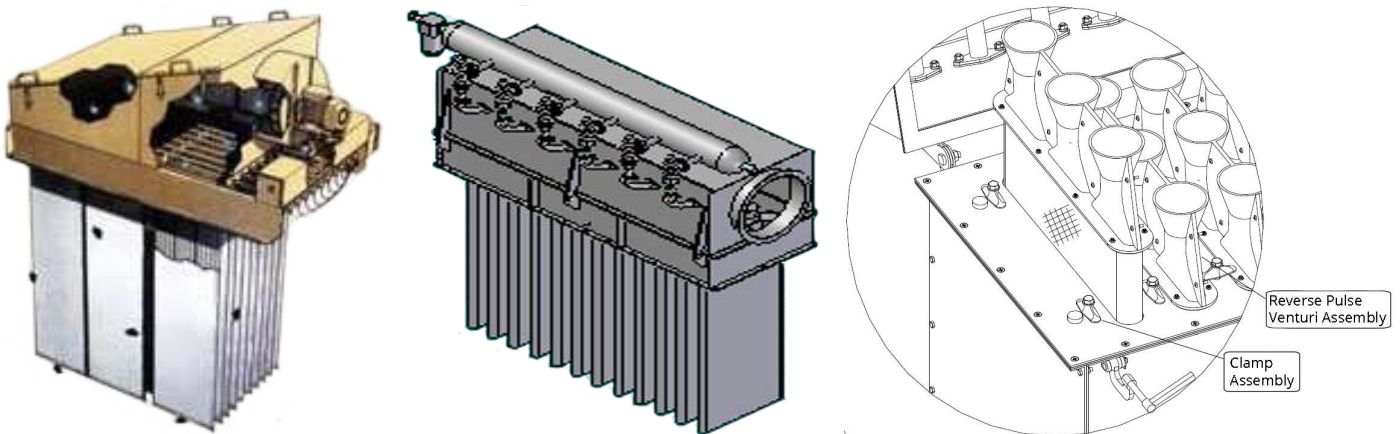

C: LNGM SERIES SQUARE HIGH PRESSURE JET FILTER DUST COLLECTOR:

- This series may be used for pretreatment of dust laden air where large particle sized dust settles within the main chamber and hopper sections, small particle sized dust is filtered through the filtering socks so as to improve the service life of the socks and increase the overall operating efficiency.
- A quick mounting and dismounting mechanism manufactured with patented technology for sock assembly is applicable for improving operation environment and work efficiency.
- The TDFK type solenoid valves enable easy assembling and disassembling for fast maintenance and the individual solenoid valves supply several socks at one time for optimum operating economic.
- The TKZM type impulse control instrument is incorporated to enable multi-circuit regulation with good adjustability, accuracy and stable operating performance.
- The power for the airlock and discharge augers on the dust collector is integrated so as to simplify collected dust discharge.
- Available in capacities from: 500-30,000 m³/hr and supplied with hopper including discharge conveyor and rotary valve.



D: TBLMy SERIES HIGH PRESSURE JET FILTER DUST COLLECTOR:

- This series features a round body assembly. The dust laden air enters the body tangentially and is separated by cyclonic action with large particle sized dust settling first, small particle sized dust is filtered through the filtering socks so as to improve the service life of the socks and increase the overall operating efficiency.
- A quick mounting and dismounting mechanism manufactured with patented technology for sock assembly is applicable for improving operation environment and work efficiency.
- The TDFK type solenoid valves are adopted for quick mounting and dismounting. Individual solenoid valves supply several socks at one time.
- The TKZM type impulse control instrument is incorporated for multi-circuit regulation with good adjustability, accuracy and stable operating performance.
- Optional conical bottom or flat bottom dust discharging mechanisms are available, so as to optimise the installation arrangement.
- Available in capacities from: 700-30,000 m³/hr.
- Fitted with heavy duty discharge rotary valve.



E: BLMB SERIES HIGH PRESSURE JET ENVELOPE FILTER DUST COLLECTOR:

- This series may be used for pretreatment of dust laden air where large particle sized dust settles within the lower hopper section and the small particle sized dust is filtered through a filtering sleeve so as to improve the service life of the sleeves.
- This series is fitted with an advanced envelope type flat sleeve and with a unique injecting device for reverse pulse cleaning of the sleeves for an improving operating environment and efficiency.
- The TDFK type solenoid valves enable easy assembling and disassembling for fast maintenance and the individual solenoid valves supply several sleeves at one time for optimum operating economic.
- The TKZM type impulse control instrument is incorporated to enable multi-circuit regulation with good adjustability, accuracy and stable operating performance.
- The power for the airlock and discharge augers on the dust collector is integrated so as to simplify collected dust discharge.
- Available in capacities from: 700-6,500 m³/hr.
- May be supplied complete with hopper and discharge rotary valve.



4 - FEATURES OF THE GRAIN TECH REVERSE PULSE FILTER COLLECTOR SERIES

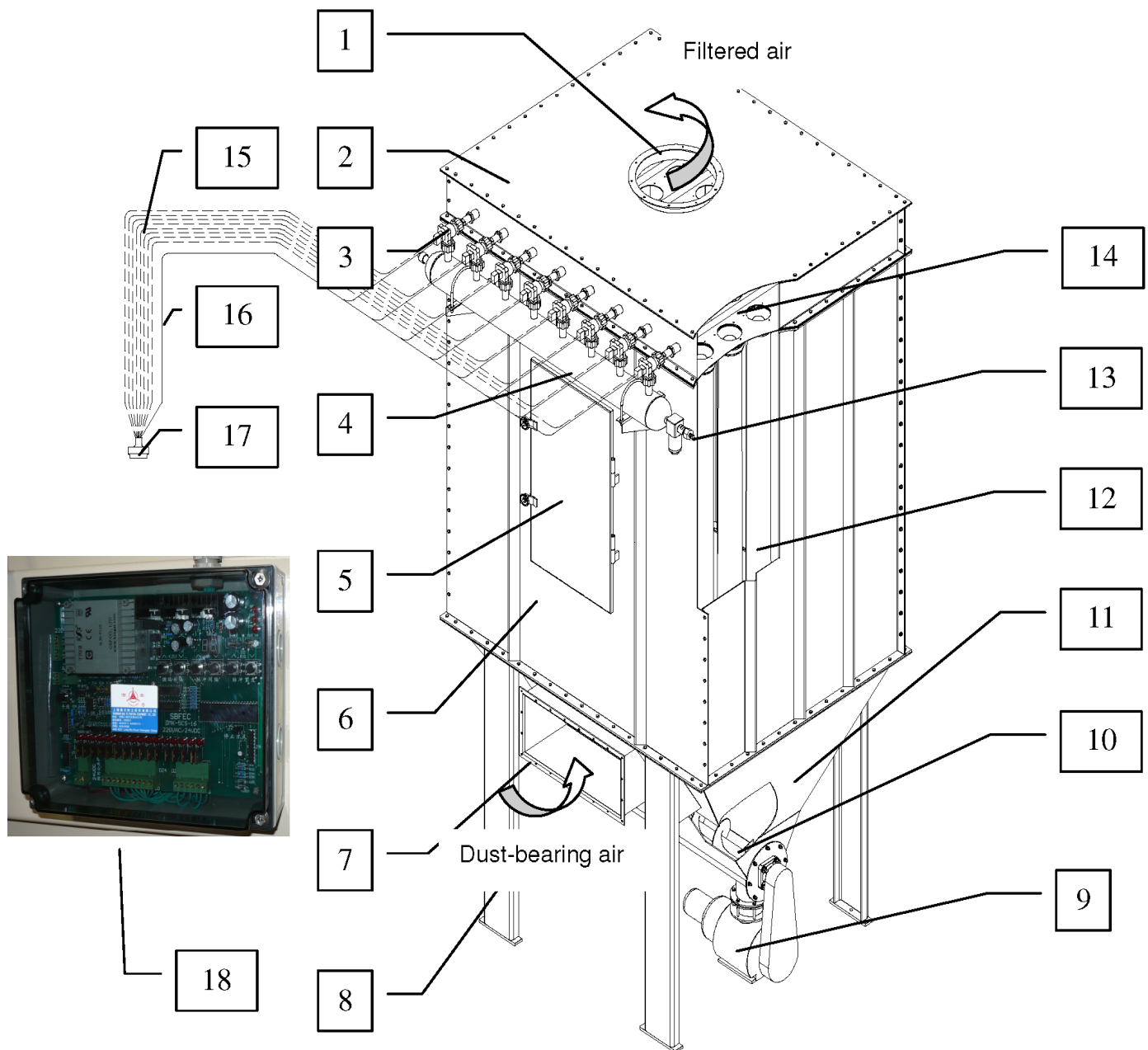

Type: LNGM Series

- | | | |
|--------------------------------|----------------------------|----------------------------------|
| 1. Air outlet | 2. Upper chamber | 3. Solenoid valve |
| 4. Air tank | 5. Access door | 6. Dust chamber |
| 7. Air inlet | 8. Support leg | 9. Airlock |
| 10. Discharge auger | 11. Discharge hopper | 12. Filtering sleeve |
| 13. Compressed air inlet | 14. Reverse pulse assembly | 15. Electrical wiring (solenoid) |
| 16. Electrical wiring (common) | 17. Plug | 18. Controller |

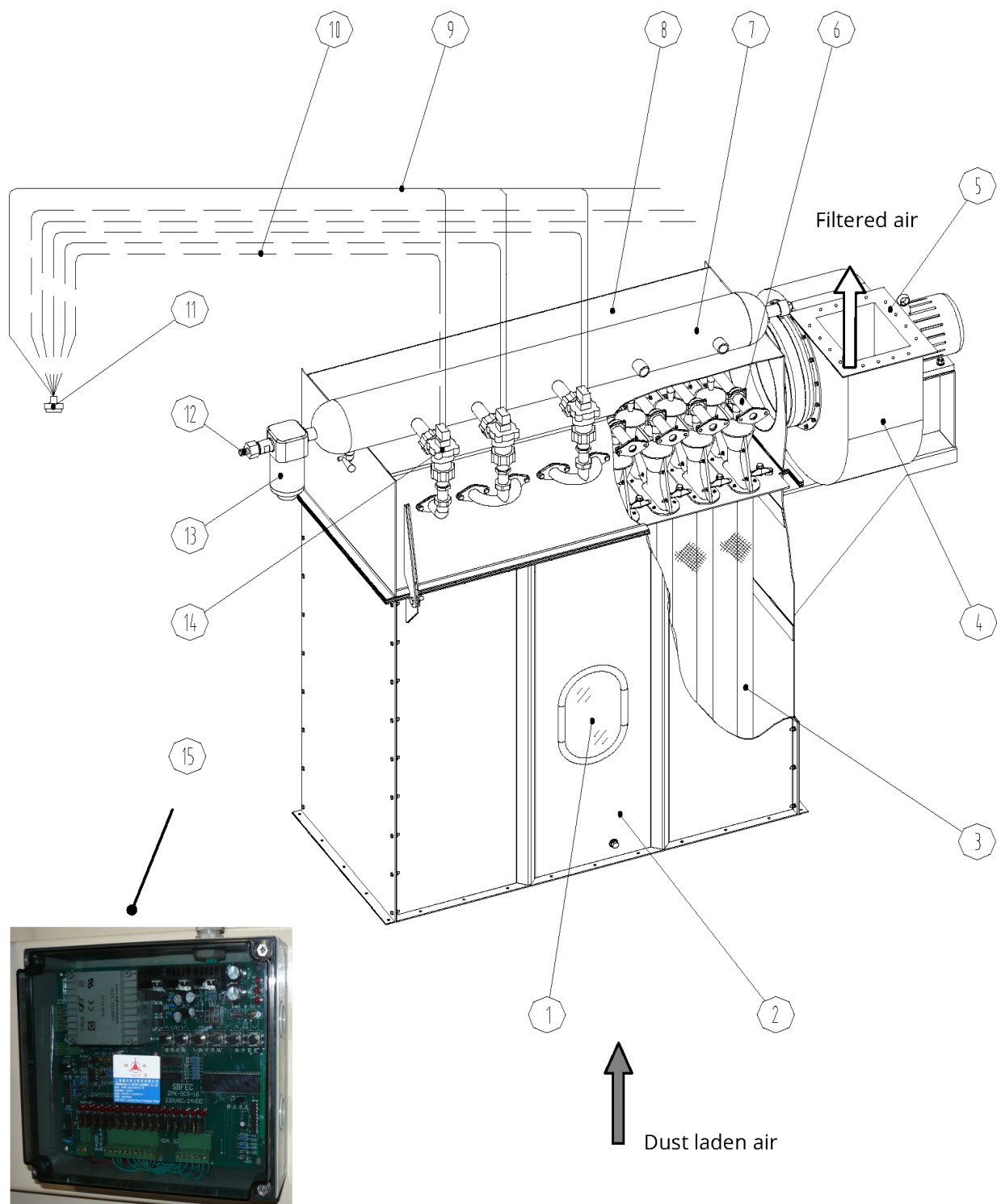

Type: TLMC Series

- | | | |
|----------------------------------|--------------------|-------------------------------|
| 1. Sight glass | 2. Dust chamber | 3. Filtering sleeve |
| 4. Fan | 5. Fan outlet | 6. Reverse pulse assembly |
| 7. Air tank | 8. Upper chamber | 9. Electrical wiring (common) |
| 10. Electrical wiring (solenoid) | 11. Plug | 12. Compressed air inlet |
| 13. Air filter | 14. Solenoid valve | 15. Controller |

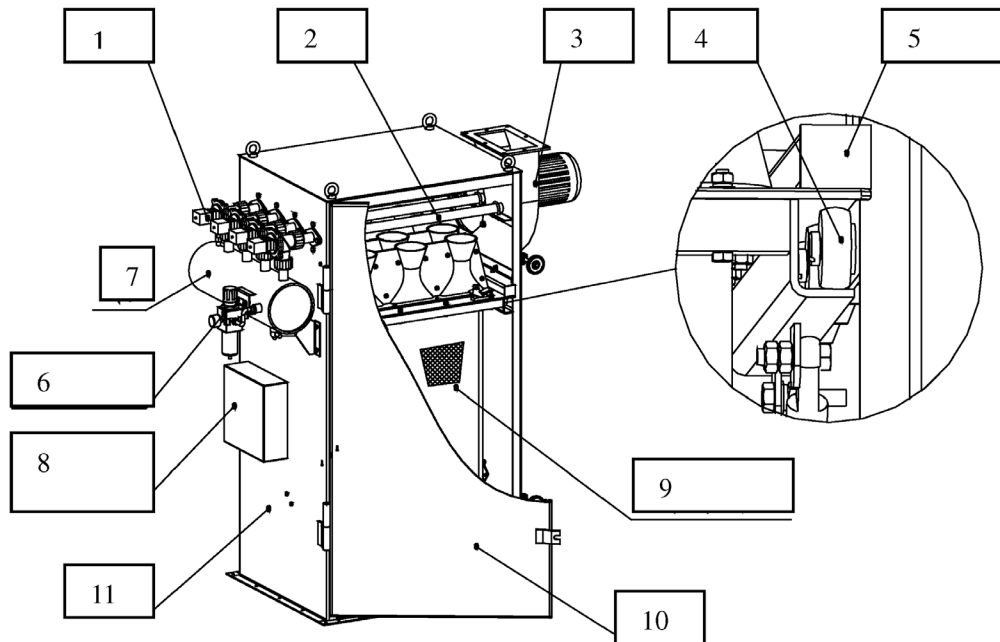

Type: BLMB Series

- | | | |
|-------------------|---------------------------|------------------|
| 1. Solenoid valve | 2. Reverse pulse assembly | 3. Fan |
| 4. Roller base | 5. Sealing plate | 6. Air filter |
| 7. Air tank | 8. Controller | 9. Filter sleeve |
| 10. Access door | 11. Main chamber | |

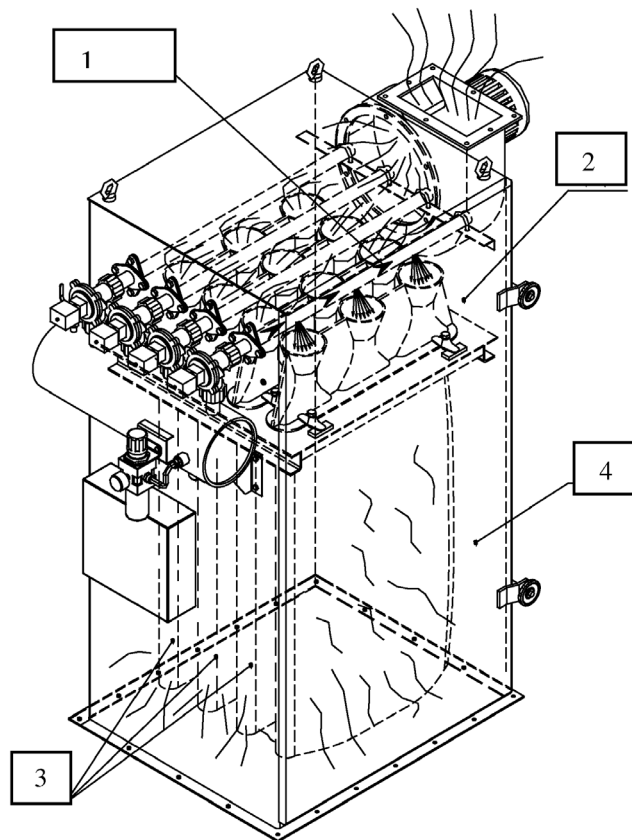

Type: BLMB Series

- | | | |
|---------------------------|------------------|---------------------|
| 1. Reverse pulse assembly | 2. Upper chamber | 3. Filtering sleeve |
| 4. Dust chamber | | |

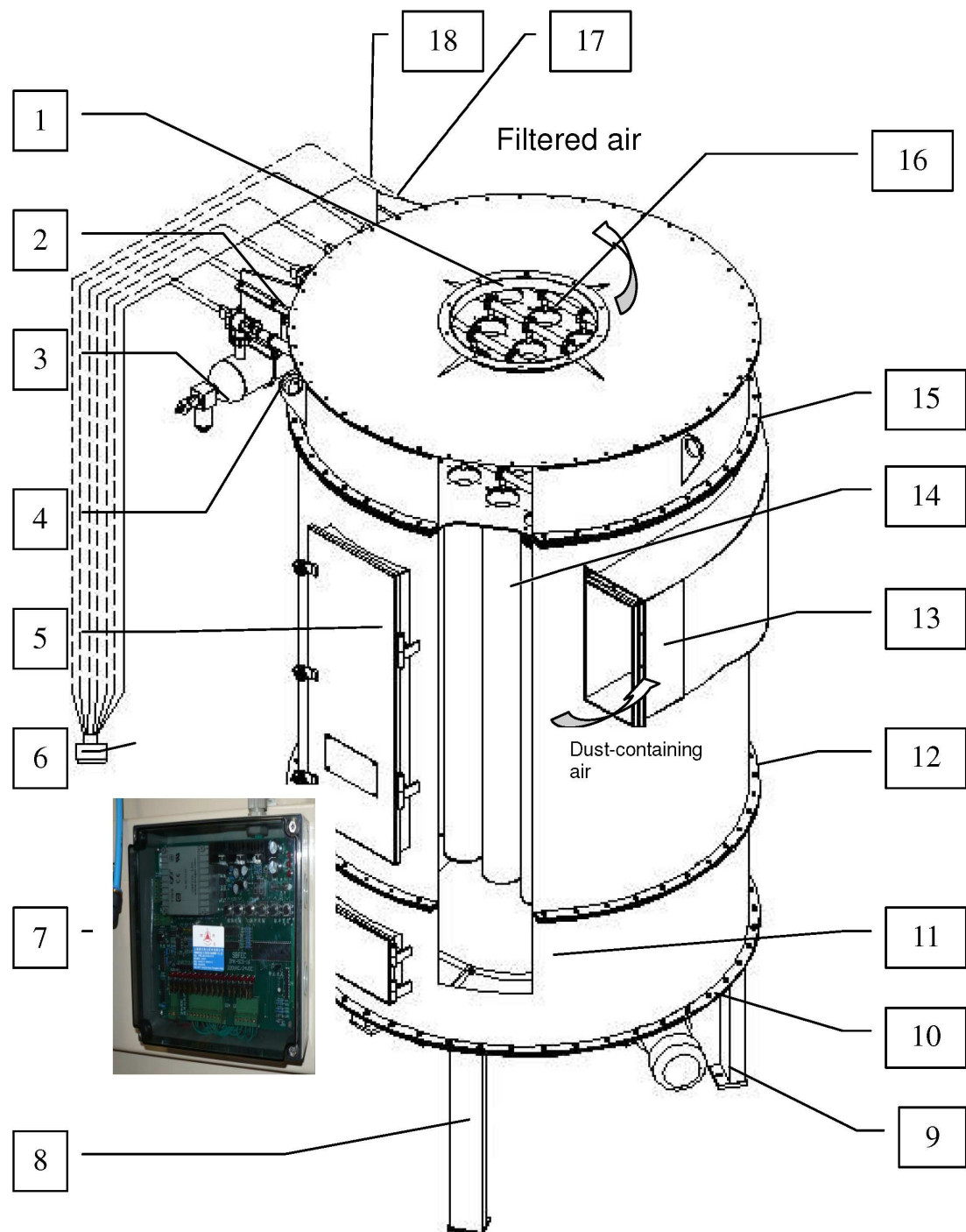

Type: TBLMd Series

- | | | |
|----------------------------|------------------------------|--------------------------------|
| 1. Air outlet | 2. Solenoid valve | 3. Compressed air inlet |
| 4. Air tank | 5. Access door | 6. Plug |
| 7. Controller | 8. Support leg | 9. Airlock |
| 10. Dust discharge chamber | 11. Sweep arm assembly | 12. Dust chamber (main) |
| 13. Air inlet | 14. Filter sock | 15. Upper chamber |
| 16. Reverse pulse assembly | 17. Electrical wire (common) | 18. Electrical wire (solenoid) |

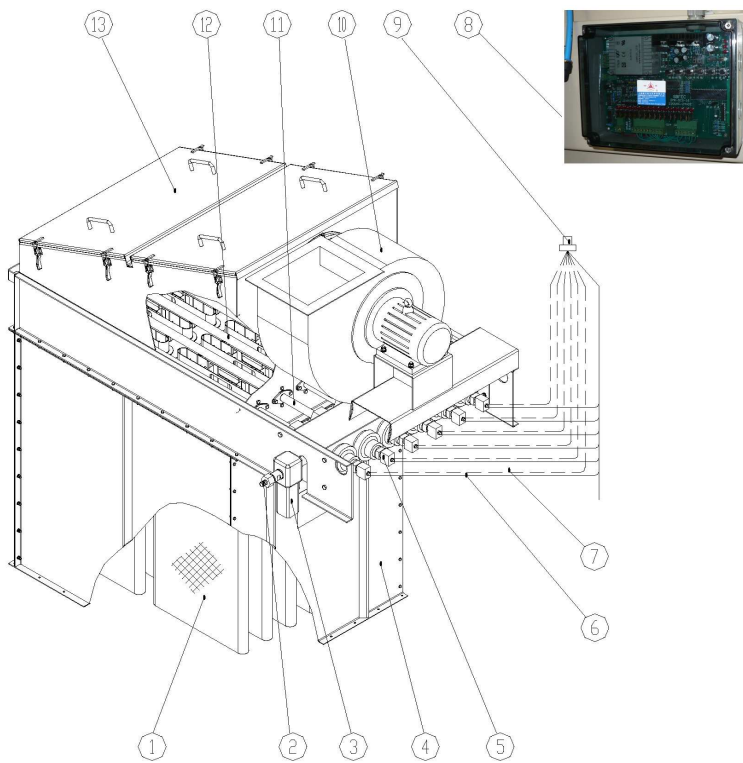

Type: TLMC Series

1. Filtering sleeve
2. Compressed air inlet
3. Air filter
4. Dust chamber
5. Solenoid valve
6. Electrical wiring (common)
7. Electrical wiring (solenoid)
8. Controller
9. Plug
10. Fan
11. Air rod connection
12. Reverse pulse rod
13. Access lid

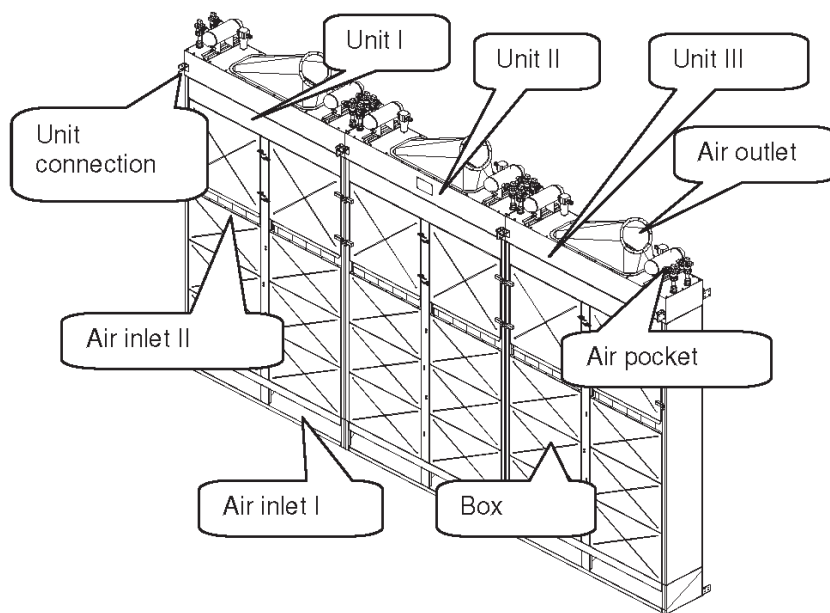

Type: TBLXG Series

Type: TBLMP/T Series

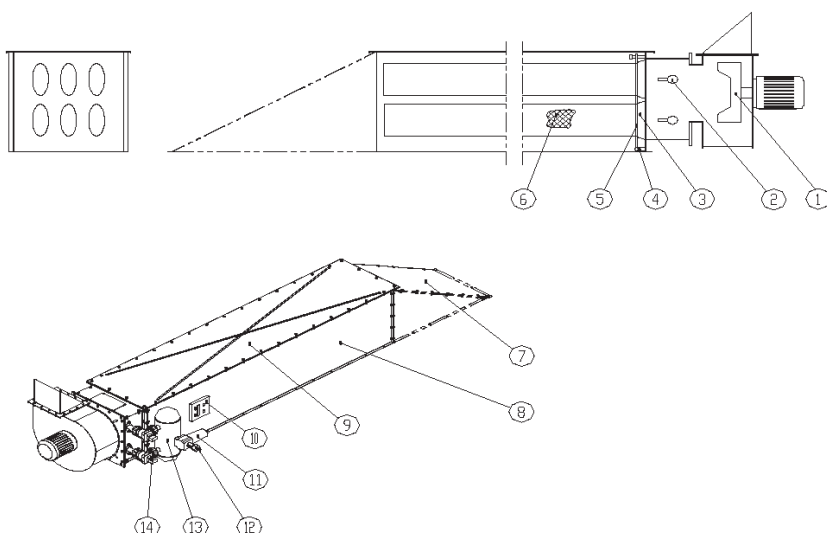

1. Fan
2. Reverse pulse rod
3. Bayoneted mechanism assembly
4. Cell plate hinge
5. Cell plate
6. Filtering sleeve
7. Discharge chamber
8. Dust chamber
9. Access lid
10. Controller
11. Air filter
12. Compressed air inlet
13. Air tank
14. Solenoid valve

5 - GRAIN TECH CYCLONE DUST COLLECTORS

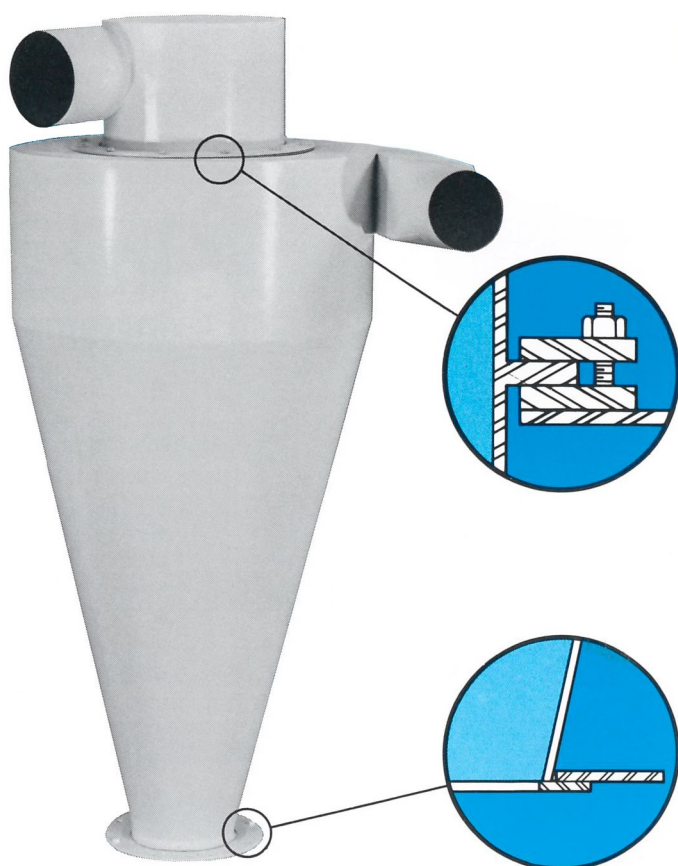

- Removes dust and other particles from processing operations
- Special design features, years of application and production experience
- Floating inlet and outlet flanges for unlimited directional rotation
- Available in a range of materials and design options
- Tangential inlet for most effective product/air entry
- Well suited for use in a wide range of industries
- Available in capacities from: 150-19,000 m³/hr

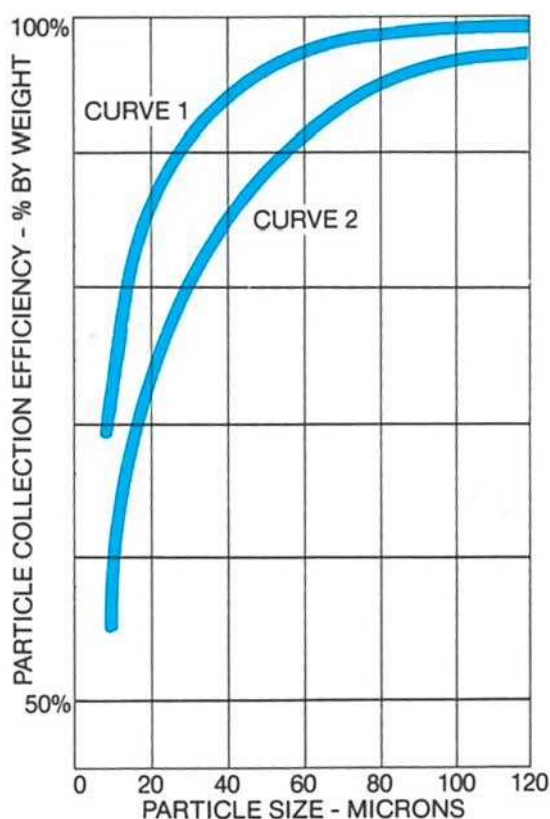

EFFECT OF A CHANGE IN FLOW RATE

In the normal air flow range of the cyclone, collection efficiency is greater with higher flow rate (curve 1) than with lower flow rate (curve 2). However, pressure loss is also increased with greater air flow and velocity.

Cyclone efficiency is affected by quality of workmanship, size of cyclone for a given air volume, particle size to be separated, particle fittings and cyclone design. Therefore exact efficiencies are difficult to predict. Grain Tech can control the design and quality of workmanship to assure you of the best possible collector available.

6 - FANS



4-72 SERIES CENTRIFUGAL VENTILATION FAN

Used to provide low pressure air handling. Suitable for handling air lower than 80°C that is harmless, non-corrosive to steel products and primarily free of dust and hard particles ($\leq 150 \text{ mg/m}^3$). The B4-72 type ventilation fan is designed to handle flammable gases.

Can be designed to handle high temperature air and include corrosion resistant contact parts.

Available in capacity range: 450-220,000 m³/hr



9-19, 9-26 SERIES HIGH PRESSURE CENTRIFUGAL FAN

Used in high pressure forced ventilation and materials handling applications. Suitable for handling air lower than 80°C that is harmless, non-corrosive to steel products and primarily free of dust and hard particles ($\leq 150 \text{ mg/m}^3$).

Can be manufactured to be explosion proof.

Available in capacity range: 550-123,000 m³/hr



C6-48 SERIES LOW PRESSURE EXHAUST FAN

Used for handling air containing wood debris, fibre and dust. A filter may be added to the air inlet if handling air containing larger particles.

May be supplied as direct drive and belt driven versions.

Available in capacity range: 750-56,000 m³/hr



SILENCERS

Grain Tech silencers are designed to suit a wide range of applications.

7 - ASSOCIATED AIR HANDLING & DUST CONTROL EQUIPMENT

In the Grain Tech range of equipment are all the components necessary to design fully integrated pneumatic conveying systems, designed to suit individual plant and application requirements. Included are a complete range of rotary valves, package blowers, diverter valves, conveying pipe and couplings together with accessories to enable plant upgrades and new installation arrangements. Design and equipment specifications may be completed using the latest computer aided software.



Rotary Valves B/T Type



Diverter Valves



Transfer Hoppers



Package Blowers



Rotary Valves D/T Type



Line Feeders



Pipes and Fittings



Slide Gate Valves



Gauges

8 - AIR & DUST CONTROL IN INDUSTRIAL PROCESSING APPLICATIONS

For many installations incorporating material handling and processing equipment, there is an integral requirement for air flow exhaust and following process air filtration as a necessary part of the operating system. The range of systems may vary from a single receiving station exhaust through to a multi-cyclone and machine combined high pressure (HP) and low pressure (LP) pneumatic material conveying and general exhaust installation. A wide range of material types may be encountered from coarse impurities separation to ultra fine particle dust as exists where fine milling for air classification.

The design of the application requirements is extremely important in ensuring that the correct equipment is incorporated for optimum process performance and it is preferable that a model of the proposed air and filtration system is prepared with all calculations completed by competent engineering design personnel.

Also of importance is the risk of dust explosions where dust concentrations exist and among the four factors i.e. oxygen, an ignition source, a defined volume and suspended dust which where co-existing may create a dust explosion. It is the suspended dust that is most easily controlled, therefore the importance of dust control is always stressed within the process design and operation especially within the grain and seed handling, flour and feed milling and associated premix operations.



Micro tip station filter arrangement

Dust in Processing Operations

Within milling processes, ingredients are reduced in particle size and added with several kinds of micro ingredients where a percentage of the components are likely to become suspended dust and incur emissions as a result of aerodynamic segregation of airborne particles created during the handling and processing of both ingredients and finished products, therefore, the physical characteristics of the dust within these processes depends on the nature of the milled components being subjected to free fall and/or some amount of turbulence inside the equipment. Due to the wide range of materials handled and spread of particle sizes, the types of dust being handled can be divided into organic dust and inorganic dust with the organic dust coming from the main ingredients having a higher micron particle size while the inorganic dusts comes from micro ingredients, minerals and inorganic nutrients.

High temperature boiler exhaust dust emissions control



In many cases the dusts to be found in processing and blending systems is characterised by its fine granularity and low moisture content, of which the coarser dust particles will settle rapidly while those smaller than 0.1mm remain suspended in the air for an appreciable time before settling, becoming the secondary dust under the impact of machine vibration or air flow.

Additionally many of these ingredients are quite expensive and improper handling will increase the risk of losing many valuable ingredients through further cross contamination, so an adequate and efficient dust control system for milling and blending installations has material recovery and anti contamination functions.

Dust Control Principle

In blending operations some dust generated or mixed with the raw materials will escape into air during tipping, cleaning, conveying and sifting etc. Further dust is created by physical disturbances such as friction and attrition during transporting these raw materials and products. Studies have shown that it is the speed of air flow that mainly determines the generation of suspended dust more than either physical impact or gravitation motion. Importantly, dust control should start with revealing how the suspended dust is generated, where it is produced and what properties it has and where it will go. Thus, air pick up points and dust control devices as well as air duct systems may then be designed and installed for the most efficient effect.

Dust Control at the Generating Source

Dust generating sources within a typical batching and blending operation include the recovery area, the drag conveyors, the elevators, the storage bins as well as the batching and mixing systems and pack off operations. To ensure adequate dust control measures, consideration needs to be given to both the dust properties and working conditions at those points.

Receiving Area

Bulk material receiving pits and dump hoppers are main sources of dust emissions as when dumping, the falling material will force the air flow towards all sides and when it hits the walls of the hopper the air flow acts on the material creating a large amount of dust, which disperses widely. Generally a spot jet filter dust collector installed on the dump pit can remove the evasive dust effectively and improve the working environment. For large intake dump pits it is advisable to install baffles to improve the dust collection efficiency. No matter what the dust control measure installed the air velocity is preferably within the range of 0.8 to 1.2 m/s, so that only dust and not the material is collected. The air volume required for effective dust collection within intake dump hoppers can be calculated by: $\text{area of grate} \times 40\text{--}45 \text{ m}^3/\text{min.m}^2$

Hand tip stations which may incorporate a vibratory sifter or hopper c/w slide gate valve suit the installation of a simple jet filter type dust collector. When tipping the material passes the screen or is collected within the hopper assembly and the dust generated is totally controlled within the filter unit under negative pressure. The material either discharges directly to the following process via the screener or an opening of the slide gate valve. The collected material on the filter sleeves is purged back into the hopper. Cross contamination is avoided in these installations.



Enclosed receiving tip

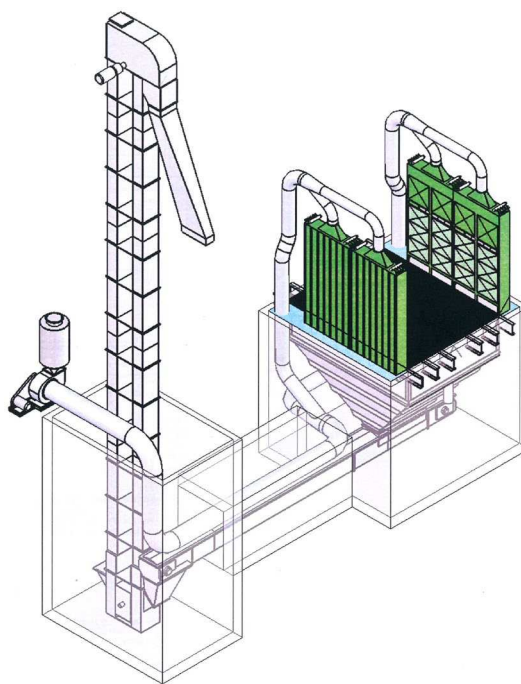

Drive over tip dust control



Hand tip station filter arrangement

Conveying Equipment

Generally dust control is not necessary for conveying equipment such as bucket elevators and screw/drag conveyors where coarse granular and higher moisture materials as well as high oil/fat ingredients are being transferred. But this position is different when handling fine and dry ingredients where there is the liability to suspend in air under the combined actions of vibration and air flow when being conveyed as may typically be found within many premix and blending operations. Dust control for conveying equipment is necessary in these cases.

There is now a change in focus where applying exhausting to material handling equipment with the preference for localised point units rather than common exhaust systems. Typically for exhausting horizontal conveyors such as drag conveyors, screw conveyors and belt conveyors etc. the oval sleeve type TBLMP filter units would be installed and for exhausting bucket elevators the vertically mounted TBLMT series will be fitted. Both of those series eliminate the need for expensive and space consuming trunking installations. The localised exhaust filter series are characterised by their compact structure, flexible installation and low air resistance. In operation they both collect dust laden air while separating the dust for return back to the source unit which enhances material utilisation and eliminates cross contamination.

The dust generated in a drag conveyor or screw conveyor is not great, therefore the air volume for the filter unit may be calculated as follows: $Q = \text{product feed volume} \times 20 \text{ (m}^3/\text{min)}$



Typical local bucket elevator filter



Boot + head exhaust arrangement for bucket elevator



Sanitary exhaust trunking



Sanitary material transfer spouting



While that for exhausting a bucket elevator may be calculated as follows: $Q = \text{sectional area of leg} \times \text{belt linear velocity} \times 1.25 \text{ (m}^3/\text{min)}$

Where large high bucket elevators are installed it is preferable to collect the dust generated at both the elevator head and boot separately which may be arranged either by combining the air duct outlets from both the head and boot into a single aspiration system; the other is to combine the air duct from the head section with that from the boot area for collection into a stand alone filter unit with the material collected being returned to the elevator. This is obviously a more costly alternative.

Multi-exhaust arrangement for ingredient storage silos + bins

Storage Hoppers, Bins and Silos

Dust control for storage facilities is one of the great challenges within bulk handling and storage systems and may be considered as separate systems as follows:

- a. Common filter collection system with manifold and separate connections to each bin/hopper. In this case the air volume is different for each leg branch with the nearest connection having the greatest volume while the furthest connection will be starved. Air volume control using butterfly valves is required for each branch connection.
- b. An alternative arrangement is to fit each bin/hopper with an independent stand alone filter unit. In this case the initial investment is significantly greater.
- c. Variation installation of the common collection system but with each branch leg to a bin/hopper fitted with an on/off butterfly valve with the common filter unit mounted above the material infeed multi-way diverter valve so that the collected dust fines only return to the bin/hopper from where the dust has been collected. In this case only a small jet filter dust collector is required having a low kW fan.

An adequate and effective venting solution should be capable of removing all of the air entering the bin/hopper as well as the air entrapped in the material feed flow while still maintaining a slight negative pressure. The volume of air entrapped is related to the discharge capacity of the delivery spout. This phenomena is the same when discharging from a batching weigher or blender.

Batching and Mixing System

During blending and mixing operations the airflow when discharging from the balance hopper above the mixer and the discharge from the mixer to the following dump hopper will not only impact the batching accuracy but also play an important part in maintaining dust control. In both events the material transfer creates internal displaced air pressure which causes dust laden air to leak out through any passable openings, including the flexible sleeve connecting the weigh hopper above the mixer and the flexible connection between the mixer and the dump hopper. An interval between the mixer and the balance hopper and also between the dump hopper and the mixer assist in regulating the displaced air flow balance, however provision needs to be made for relief venting of both the balance hopper and the mixer for effective reduction in pressurisation. All flexible sleeves and vent socks need to be cleaned reasonably frequently for efficient operation. Efficient pressurised air venting reduces likely variation in weight influence on the load cell operation. In any case all covers, doors, shaft seals and flange connections should be thoroughly checked to ensure that evasive dust leakage is eliminated.

Bagging System

For total dust control three pick up points are mandatory. One at the discharge outlet from the feeder supplying the bagging hopper with the other two either side of the bag clamps just above the bag placement position on the spout. For effective evasive dust control adequate air volume and velocity needs to be provided and a correctly sized exhaust fan and ducting needs to be installed.

Selection of Dust Filter Collectors

The selection of dust collection and associated equipment is very important within processing applications and needs to be considered in the context relevant to the type of materials and ingredients being handled. The sizing of filters, ducting and type of filtering sleeves needs to be thoroughly evaluated and the individual collection points calculated according to requirements so that the ducting, exhaust fans and filter unit may be sized for optimum efficiency. Within general exhaust applications an air velocity of 65 m/min has proven to be practical and satisfactory for the dust filter collector.

Conclusion

Traditionally process dust control solutions have focused on having air tight enclosures supplemented by dust removal via common exhaust ducting to centralised filter units. Practical experience within a wide range of processing and related installations highlights the advantages of adopting localised spot dust filter collectors for different dust generating points and only those dusts that have the same characteristics are collected together by a central ducted dust control system.

Today through the incorporation of efficient dust containment measures and high efficiency dust collectors correctly sized for the load and dust type it is practical to have process milling, blending, bulk handling and packing facilities operating with a more healthy and friendly environment.



GRAIN TECH LTD

PROCESSING, HANDLING & STORAGE SYSTEMS

55B Druces Road, Manukau, Auckland 2104, New Zealand

PO Box 97420, Manukau City, Auckland 2241, New Zealand

Tel: 0064 9 263 6926 Fax: 0064 9 262 1335

Email: admin@graintech.co.nz Website: www.graintech.co.nz

AN ENGINEERING OFFICE THAT PUTS IDEAS INTO ACTION

We build systems for raw material

- In all sections of the food industry
- In the chemical industry
- In the agricultural commodity industry
- In the waste treatment / disposal industry

We have the perfect storage method

- With outdoor and indoor silos
- Homogenizing silos
- With Grain Tech's fluidised bed discharge systems
- Standard or tailored design for all additive ingredients and liquids

We convey products gently

- Through all types of pneumatic systems
- Through Grain Tech's pressure vessels
- Through vibratory conveying systems
- Through air slides and metering screws
- Through bucket elevators, various types of belt and drag link conveyors
- Through aero-mechanical conveyors

We sift raw materials to the highest specifications

- With orbital and gyratory sifters
- With screeners and rotary classifiers
- With vibratory and pneumatic in line sifters
- For classification control and final security sifting

We pulverise and mill raw materials to attain exact particle sizings

- By pre-breaking, hammer milling and crushing
- By roller milling, granulating and cutting

Our mixing achieves better quality

- Mechanically and pneumatically
- With or without liquid additions
- In batch or continuous systems

We can weigh and meter within extremely tight tolerances

- With Grain Tech's weigh mix systems
- Incorporating totally integrated weighing and processing control systems
- Using screw and vibratory metering feeders
- We change the characteristics and shape of commodities and materials

We effectively classify raw materials and finished product

- With gravity and air separators
- With mechanical graders and screeners

We have drying and cooling systems to meet most product types

- By fluid bed and vibratory conveying units
- By pneumatic circuits
- By column, tower and conveyor systems

We change the characteristics and shape of commodities and materials

- With pelletising and agglomeration processes
- By extrusion processors

We manufacture and supply the following machines

- Rotary valves, blower units, diverter valves, multi-way valves, cyclones and transit separators
- Pipe systems, filter collectors
- Shut off valves, slide gate valves
- Hammer mills, crushers, pulverisers, roller mills, flaking mills
- Extruders, pelletisers, agglomerators
- Silos, bins and hoppers, discharging devices
- Mixers, blenders, sifters
- Control systems and measuring / metering equipment
- Bagging, packing and handling equipment

Special processing systems or machines

- Extrusion processing lines
- Complete cereal processing lines
- Complete animal feeds manufacturing